

**TECHNICAL DATA FOR MATCHING BURNER ON BOILER:
SB/V**

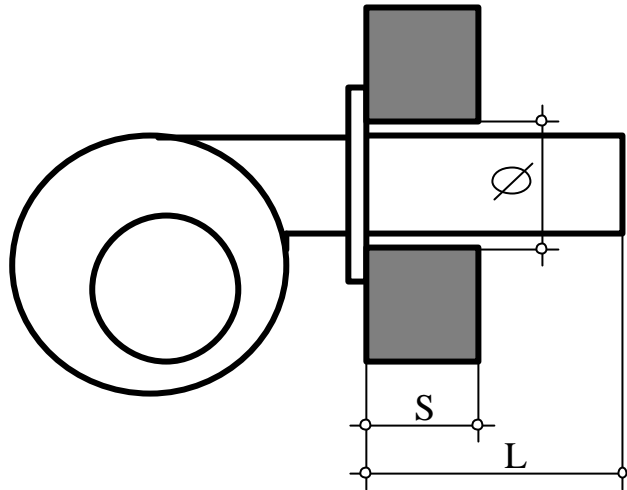

Boiler model (pressure 12 ATE)	Nominal capacity kW	Furnace capacity kW	Furnace pressure mbar	Cement hole on front door Ø mm	Front door thickness S mm	Burner head length min/max L mm	Type (passing flame or flame inversion)	Furnace Internal diameter mm	Furnace internal length mm
SB/V 2	1385	1567	3,5	As per sketch of drilling	220	As per indication of Burner- man	passing flame	650	2950
SB/V 3	2077	2334	5,5		220			780	3200
SB/V 4	2769	3112	6,0		220			860	3300
SB/V 5	3462	3891	7,5		220			860	3700
SB/V 6	4155	4668	8,0		220			950	3700
SB/V 7	4847	5446	8,5		220			1000	3850
SB/V 8	5540	6226	10,0		220			1000	4250
SB/V 10	6923	7780	7,5		220			1050	4850
SB/V 12	8308	9335	7,8		220			1100	4950
SB/V 15	10468	11763	8,0		220			1250	5150
SB/V 18	12462	14005	9,0		220			1350	6050
SB/V 20	13850	15565	11,0		220			1400	6600